

FINISH SCHEDULE					
ROOM NAME	FLOOR	BASE	WALL	CEILING	01-11-19
(100) DINING ROOM	T200 24" X 24" TILE	T109 6" X 36" TILE	P101, P104 T109 W102 WALL COVERING	C1 2' X 2' ARMSTRONG, SEPIA #PN81311 C3 GYP BOARD W/ PAINT P103	
(101) SERVING AREA	S1 S2 PLAIN ABRASIVE IN HIGH TRAFFIC AREAS	S1 6" H CONT. (KITCHEN EQUIPMENT ON 6" NSF APPROVED LEGS)	T109 TILE	C3 GYP BOARD W/ SMOOTH WASHABLE PAINT	
(102) DRIVE-THRU STATION	S1 S2 PLAIN ABRASIVE IN HIGH TRAFFIC AREAS	S1 6" H CONT. (KITCHEN EQUIPMENT ON 6" NSF APPROVED LEGS)	WP1 FRP PANEL	C2 2' X 4' SUSPENDED GRID WASHABLE VINYL COATED GYP BOARD PANELS	
(103) KITCHEN	S1 S2 PLAIN ABRASIVE IN HIGH TRAFFIC AREAS	S1 6" H CONT. (KITCHEN EQUIPMENT ON 6" NSF APPROVED LEGS)	WP3 S.S. BEHIND COOK LINE WP1 FRP PANEL	C2 2' X 4' SUSPENDED GRID WASHABLE VINYL COATED GYP BOARD PANELS	
(104) KITCHEN PREP.	S1 S2 PLAIN ABRASIVE IN HIGH TRAFFIC AREAS	S1 6" H CONT. (KITCHEN EQUIPMENT ON 6" NSF APPROVED LEGS)	WP1 FRP PANEL	C2 2' X 4' SUSPENDED GRID WASHABLE VINYL COATED GYP BOARD PANELS	
(105) WALK-IN COOLER	S1 PLAIN ABRASIVE IN HIGH TRAFFIC AREAS S2 GALVANIZED STAINLESS STEEL SILIKAL UNDER WIF SUBFLOOR	S.S. / ALUMINUM WITH 3/4" RADIUS	EXT S.S. INT ALUMINUM GALVANIZED S.S.	ALUMINUM GALVANIZED STAINLESS STEEL	
(105A) WALK-IN FREEZER	S1 GALVANIZED STAINLESS STEEL SILIKAL UNDER WIF SUBFLOOR	S.S. / ALUMINUM WITH 3/4" RADIUS	EXT S.S. INT ALUMINUM GALVANIZED S.S.	ALUMINUM GALVANIZED STAINLESS STEEL	
(106) MEN'S ROOM	T200 24" X 24" TILE	SCHLUTER	T108 TILE	C3 GYB BOARD W/ P101 SMOOTH WASHABLE PAINT	
(107) WOMEN'S ROOM	T200 24" X 24" TILE	SCHLUTER	T108 TILE	C3 GYB BOARD W/ P101 SMOOTH WASHABLE PAINT	
(108) VESTIBULE	T200 24" X 24" TILE	T109 6" X 36" TILE	P104 PAINT GYB BOARD T109 TILE	C3 GYB BOARD W/ P101 SMOOTH WASHABLE PAINT	
(109) STORAGE ROOM	T200 24" X 24" TILE	T109 6" X 36" TILE	WP1 FRP PANEL	C3 GYB BOARD W/ P101 SMOOTH WASHABLE PAINT	
(110) EXTERIOR STORAGE	SEALED CONCRETE, SMOOTH FINISH	-	WP1 FRP PANEL	C3 GYB BOARD W/ P101 SMOOTH WASHABLE PAINT	
(111) ENTRY VESTIBULE	T200 24" X 24" TILE M100 4" X 6" MAT	T109 6" X 36" TILE	P104 T109 PAINT TILE	C3 GYB BOARD W/ P101 SMOOTH WASHABLE PAINT	

DOOR & HARDWARE SCHEDULE									
INSTALLED AND FURNISHED BY: G.C. UNLESS NOTED OTHERWISE									
NO.	DOOR MATERIAL	SIZE	FRAME	FACE/EDGE	THK.	CORE	LITE	RATE	REMARKS
(01)	ALUMINUM STOREFRONT	3'-0" X 7'-0"	ALUM.	DARK BRONZE ANODIZED ALUM.	1 1/2"	HOLLOW	GLASS	-	PROVIDE PULL ON EXTERIOR SIDE
(02)	ALUMINUM STOREFRONT	3'-6" X 7'-0"	ALUM.	DARK BRONZE ANODIZED ALUM.	1 1/2"	HOLLOW	GLASS	-	PROVIDE PULL ON EXTERIOR SIDE
(03)	S.C. WOOD	3'-0" X 7'-0"	H. MTL.	PLASTIC LAMINATE PRE-FINISHED	1 1/2"	SOLID	-	-	KICKPLATE ON EACH SIDE OF DOOR
(04)	S.C. WOOD	(2) 2'-0" X 7'-0"	H. MTL.	PLASTIC LAMINATE PRE-FINISHED	1 1/2"	SOLID	-	-	KICKPLATE ON VESTIBULE SIDE OF DOORS.
(05)	HOLLOW METAL	3'-6" X 7'-0"	H. MTL.	PAINTED	1 1/2"	INSUL.	-	-	KICKPLATE ON INT. SIDE OF DOOR
(06)	HOLLOW METAL	(2) 3'-0" X 7'-0"	H. MTL.	PAINTED	1 1/2"	INSUL.	-	-	WITH LOUVERED VENT & BUG SCREEN
(07)	HOLLOW METAL	3'-0" X 7'-0"	H. MTL.	PAINTED	1 1/2"	INSUL.	-	-	
(08)	ALUM. STORE VESTIBULE	3'-0" X 7'-0"	ALUM.	DARK BRONZE ANODIZED ALUM.	1 1/2"	HOLLOW	GLASS	-	

WALL SCHEDULE									
INSTALLED AND FURNISHED BY: G.C. UNLESS NOTED OTHERWISE									
NO.	DESCRIPTION								
(01)	3-5/8" 20GA. METAL STUD WALL W/ 1/2" TYPE "X" GYP. BOARD BOTH SIDES (SEE ARCHITECTURAL DETAILS & ELEVATIONS)								
(02)	3-5/8" 20GA. METAL STUD WALL W/ 1/2" TYPE "X" GYP. BOARD ON ONE SIDE (SEE ARCHITECTURAL DETAILS & ELEVATIONS)								
(03)	(2) 3-5/8" 20GA. METAL STUD WALLS W/ 1/2" TYPE "X" GYP. BOARD BOTH SIDES (SEE ARCHITECTURAL DETAILS & ELEVATIONS)								
(04)	3-5/8" 20GA. METAL STUD LOW WALL W/ 1/2" TYPE "X" GYP. BD BOTH SIDES. PROVIDE 3 1/2" KNEE-WALL BRACE/POST @ CORNERS AND @ 48" O.C.								
(05)	6" 20GA. METAL STUD WALL W/ 1/2" TYPE "X" GYP. BOARD BOTH SIDES (SEE ARCHITECTURAL DETAILS & ELEVATIONS)								
(06)	6" 20GA. METAL STUD WALL W/ 1/2" TYPE "X" GYP. BOARD ONE SIDE (SEE ARCHITECTURAL DETAILS & ELEVATIONS)								
(07)	6" 20GA. METAL STUD LOW WALL W/ 1/2" TYPE "X" GYP. BOARD BOTH SIDES. PROVIDE 3 1/2" KNEE-WALL BRACE/POST @ CORNERS AND @ 48" O.C.								
(08)	2 1/2" 20GA. METAL STUD FURRING W/ 1/2" TYPE "X" GYP. BOARD ON ONE SIDE. REFER DETAILS FOR FURRING DISTANCE								

WALL PANEL SCHEDULE				
INSTALLED AND FURNISHED BY: G.C. UNLESS NOTED OTHERWISE				
NO	MANUFACTURER	DESCRIPTION	MFG #	COLOR FINISH
WP1	CRANE COMPOSITES INC.	F.R.P. THICKNESS: .075	LB03.14	#636 (GRAY), S/MSM
WP2	-	S.S. PANEL (22 GA)	-	BRUSHED FINISH
WP3	-	S.S. PANEL (22 GA)	-	DIAMOND PATTERN FINISH
WP4	NOT USED			
WP5	NOT USED			
WP6	NOT USED			
WP7	NOT USED			
W109	WOLF GORDON	RED BAMBOO	-	-
W103	WOLF GORDON	CLOUD WALLCOVERING	-	-

SPECIAL SURFACE SCHEDULE					
INSTALLED AND FURNISHED BY: G.C. UNLESS NOTED OTHERWISE					
NO	MANUFACTURER	PRODUCT	MFG #	STAIN / COLOR	FINIISH
QZ-3	NOT USED				
QZ-6	NOT USED				
QZ-7	CORIAN	ARTIFICIAL QUARTZ	-	LONDON SKY	POLISHED
QZ-9	DALTILE	ARTIFICIAL QUARTZ	-	BROADWAY BLACK	POLISHED

INTERIOR PAINT SCHEDULE				
INSTALLED AND FURNISHED BY: G.C. UNLESS NOTED OTHERWISE				
NO	MANUFACTURER	MFG #	COLOR	REMARK
PA5	SHERWIN-WILLIAMS	SW 7065	ARGOS	PROMAR 200, ZERO VOC, LATEX SEMI-GLOSS
PA8	NOT USED			
P101	SHERWIN-WILLIAMS	SW 6252	ICE CUBE	PROMAR 200, ZERO VOC, LATEX EGG-SHELL
P102	NOT USED			
P103	NOT USED			
P104	SHERWIN-WILLIAMS	SW 2850	CHELSEA GRAY	PROMAR 200, ZERO VOC, LATEX EGG-SHELL
P105	NOT USED			
P106	SHERWIN-WILLIAMS	SW 7020	BLACK FOX	DTM ACRYLIC GLOSS, LOW VOC
P205	SHERWIN-WILLIAMS	SW 7675	SEALSKIN	PROMAR 200, ZERO VOC, LATEX EGG-SHELL

TILE SCHEDULE (SEE SHEET A-104)			
NO	MANUFACTURER	MFG #	COLOR
PA5	SHERWIN-WILLIAMS	SW 7065	ARGOS
PA8	NOT USED		
P101	SHERWIN-WILLIAMS	SW 6252	ICE CUBE
P102	NOT USED		
P103	NOT USED		
P104	SHERWIN-WILLIAMS	SW 2850	CHELSEA GRAY
P105	NOT USED		
P106	SHERWIN-WILLIAMS	SW 7020	BLACK FOX
P205	SHERWIN-WILLIAMS	SW 7675	SEALSKIN

WALL LEGEND

NEW EXTERIOR WALL

NEW EXTERIOR WALL
FRAMED WITH
STRUCTURAL STEEL STUDS

NEW INTERIOR WALL (FULL HT.)

NEW INTERIOR WALL (LOW WALL
- REF. ELEV. & DETAILS)

WALK-IN BOX PANEL

NOTE: THE FOLLOWING STAINLESS STEEL PROVIDED BY PX-INSTALLED BY G.C.:

- PANEL DIVIDERS AT WP3
- INSIDE CORNER AT WP3 TO WP2
- FLASHING AT TOP OF BASE WP3
- WP2 PIECE AT LENGTH OF WALL

NOTE: THE FOLLOWING STAINLESS STEEL PROVIDED BY G.C.-INSTALLED BY G.C.:

- INSTALL 18 GA STAINLESS STEEL CORNER GUARD & WALL CAP INSIDE KITCHEN

18 GA. STAINLESS STEEL CORNER GUARD - FULL HT.

18 GA. STAINLESS STEEL CORNER GUARD - 4'-0" HIGH

18 GA. STAINLESS STEEL CORNER GUARD/FRAME - ALL AROUND PERIMETER OF OPENING - FRAME TO BE WELDED WITH MITERED CORNERS TO FORM SINGLE UNIT.

18 GA. STAINLESS STEEL WALL CAP

ALL OTHER STAINLESS STEEL BY G.C.

NOTE!!!!!!!!!!!!!!:

*ALL INTERIOR DIMENSIONS ARE TO FACE OF GYPSUM BOARD

NOTE:

CONTRACTOR TO NOTIFY 3rd PARTY VENDOR, PER THE VENDOR LIST, FOR WALL PRE-TREAT BEFORE CLOSING WALLS

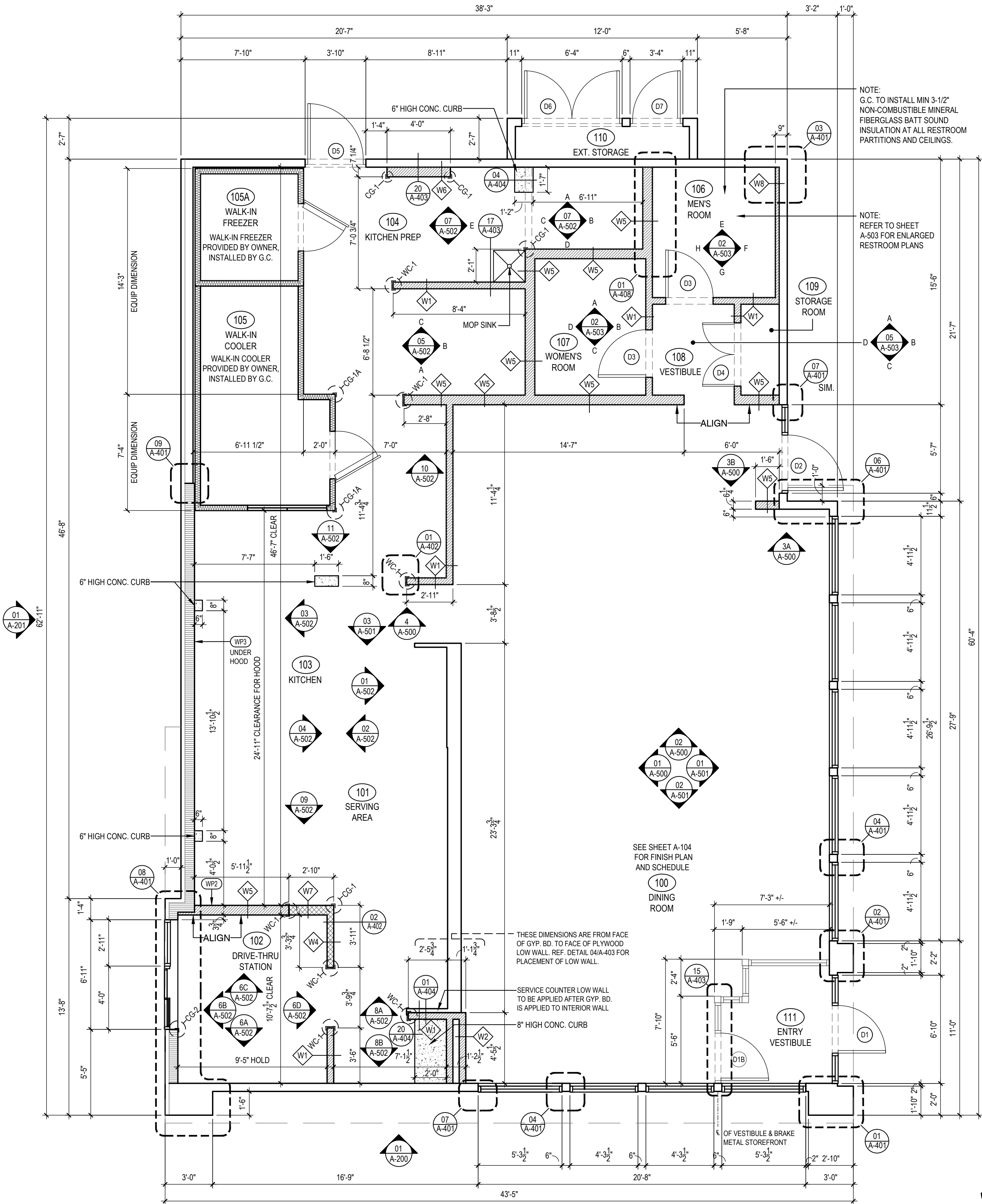

FLOOR PLAN

1

Scale= 1/4" = 1'-0"

A-103



PANDA EXPRESS, INC.
1683 Walnut Grove Ave.
Rosemead, California
91770

Telephone: 626.799.9898
Facsimile: 626.372.8288

All ideas, designs, arrangement and plans indicated or represented by this drawing are the property of Panda Express Inc. and were created for use on this specific project. None of these ideas, designs, arrangements or plans may be used by or disclosed to any person, firm, or corporation without the written permission of Panda Express Inc.

REVISIONS:

ISSUE DATE:

1ST SITE PLAN REVIEW 02-16-21
2ND PERMIT/BID SET 04-09-21

DRAWN BY: KB

PANDA PROJECT #: S8-22-D8193

PANDA STORE #: -

ARCH PROJECT #: 20044.021



hckloverarchitect

8813 PENROSE LANE, SUITE 400
LENEXA, KS 66219
ph: 913.649.8181 • fx: 913.649.1275

PANDA EXPRESS

TRUE WARM & WELCOME
1485 MAIN ST.
HAMILTON, OH 45013

A-103

FLOOR PLAN

TRUE WARM & WELCOME 2300 R5