

PARCEL MAP NO 2156 for RALPH PALMER — 393-O.R.-262

BEING A DIVISION OF PARCEL 2 OF 28-M-3 & LOCATED IN SECTION 31, T.7 N., R.12 E., M.D.M. — AMADOR COUNTY, CALIF.

TOMA & ANDERSON — LICENSED LAND SURVEYORS — 41 SUMMIT ST., JACKSON, CALIF.

SEPTEMBER, 1985

SCALE: 1" = 100'

(M) 20-20-58 W 111

NOTES & LEGEND

- DENOTES 5/8 INCH STEEL ROD TAGGED L.S. 3570 SET ON THIS SURVEY.
- ⊕ DENOTES 1/2 INCH STEEL ROD TAGGED R.C.E. 1706 FOUND.
- ⊙ DENOTES 3/8 INCH STEEL ROD TAGGED R.C.E. 1706 FOUND.
- DENOTES 1/2 INCH IRON PIPE TAGGED L.S. 3570 FOUND.
- ◊ DENOTES FENCE ANGLE POST TAGGED L.S. 3570 FOUND.
- MATHEMATICAL POINT ONLY-NOTHING FOUND OR SET.

THE MERIDIAN OF THIS SURVEY IS IDENTICAL WITH THE MERIDIAN OF THAT CERTAIN OFFICIAL MAP RECORDED IN BOOK 28 OF MAPS AND PLATS AT PAGE 3, AMADOR COUNTY RECORDS, BEARING N. 90° E.

////// DENOTES PORTION PARCELS 2A AND 2B DEDICATED TO AMADOR COUNTY.

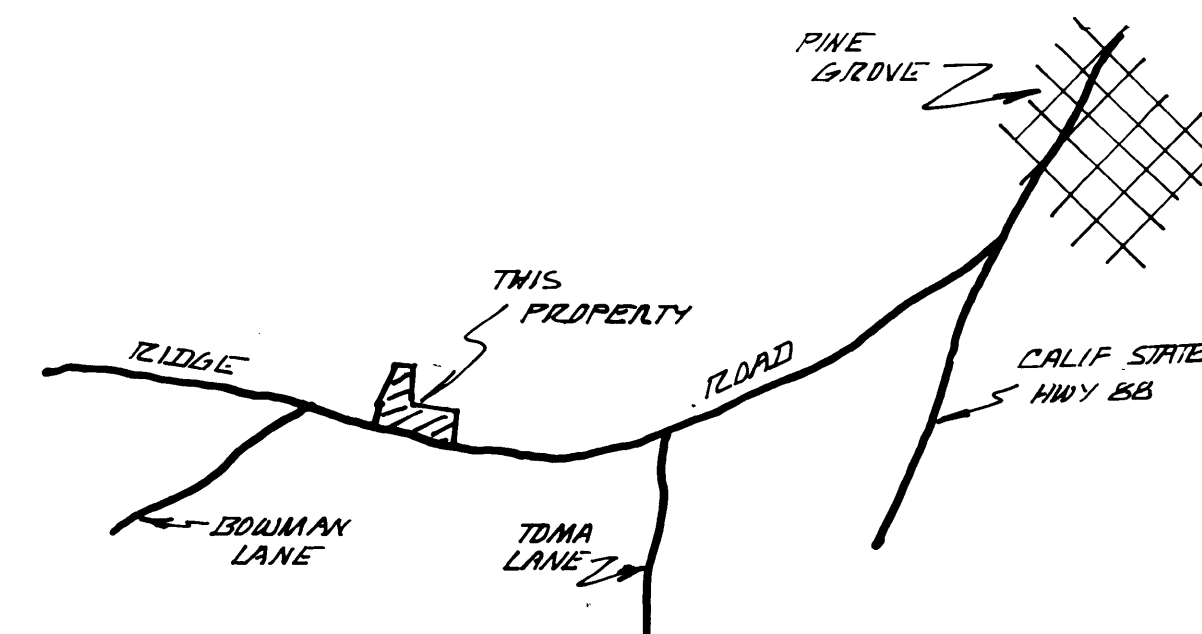

VICINITY SKETCH
NO SCALE