

CORNER RECORD

Document Number CR 5296

City of OAKLAND County of ALAMEDA, California

Brief Legal Description BRASS DISC MONUMENT LOCATED WITHIN CLAREMONT AVENUE. (5SW39-R)

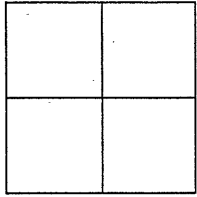

CORNER RECORD

Government Corner ☐ Control ☒  
Meander ☐ Property ☐  
Rancho ☐ Other ☐  
Date of Survey 10/18/12

COORDINATES  
(Optional)

N. \_\_\_\_\_  
E. \_\_\_\_\_  
Zone \_\_\_\_\_ Datum \_\_\_\_\_  
Elev. \_\_\_\_\_

Corner — Left as found ☒ Found and tagged ☐ Established ☐ Reestablished ☐ Rebuilt ☐

Identification and type of corner found: Evidence used to identify or procedure used to establish of reestablish the corner:  
FOUND BRASS DISC MONUMENT LOCATED WITHIN CLAREMONT AVENUE.

AS SHOWN ON CITY OF OAKLAND MONUMENT MAP, PAGE 310.

THIS POINT WAS REFERENCED PRIOR TO A CONSTRUCTION PROJECT IN THE VICINITY.

A description of the physical condition of the monument as found and as set or reset: \_\_\_\_\_  
FOUND AND SET POINTS AS SHOWN ON PAGE 2.

THESE TIES ARE FOR THE PURPOSE OF PERPETUATING THE FOUND MONUMENTATION.

NO CLAIM IS MADE AS TO THE RELATIONSHIP OF THE POINTS OR LINES SHOWN HEREON  
TO TRUE BOUNDARY LOCATIONS.

SURVEYOR'S STATEMENT

This Corner Record was prepared by me or under my direction in conformance with  
the Land Surveyors' Act on OCTOBER 24, 20 12.  
Signed Vincent H. Cunha L.S. Number LS 4520  
VINCENT H. CUNHA



COUNTY SURVEYOR'S STATEMENT

This Corner Record was received 12-18-2012 and examined  
and filed 4-17-2013.  
Signed [Signature] Title COUNTY SURVEYOR

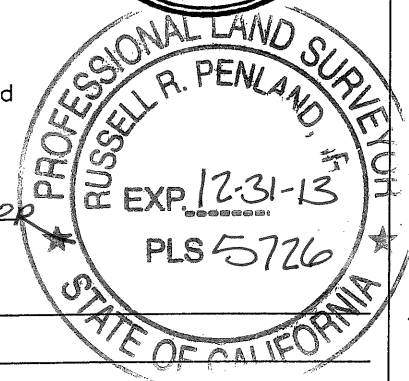

County Surveyor's Comment \_\_\_\_\_



SCALE: 1"=30'

### LEGEND

- FOUND BRASS DISC IN MONUMENT WELL (5SW39 R)
- ⊙ FOUND MONUMENT (PER CR4314)
- ✕ FOUND CUT CROSS IN CONCRETE (PER CR4315)
- AA##A# ALAMEDA COUNTY MONUMENT ID

CLAREMONT  
AVENUE

HUDSON  
STREET

24  
GROVE-SHAFTER FREEWAY

